

SECTION A-A

LEGEND FOR STEEL MEMBERS

- A - NB 150 OD 165.1 X 4.8mm THICK @ 17.9 Kg/m
- B - NB 150 OD 165.1 X 4.8mm THICK @ 17.9 Kg/m
- C - NB 150 OD 165.1 X 4.8mm THICK @ 17.9 Kg/m
- D - NB 50 OD 60.3 / 3.6mm THICK @ 5.03 Kg/m

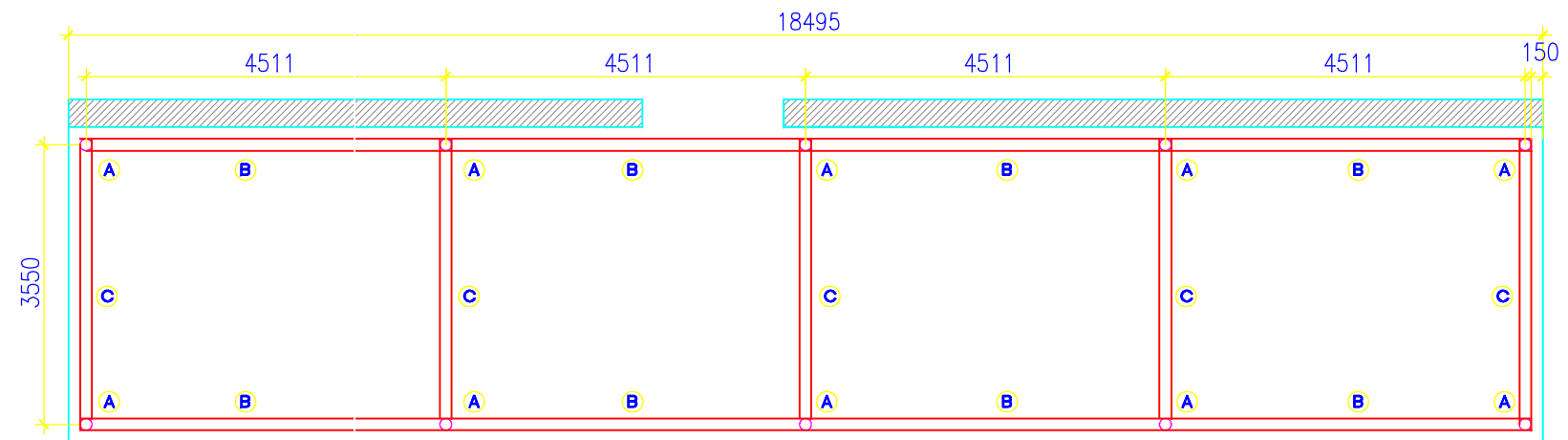

PLAN OF COLUMN & TRUSS

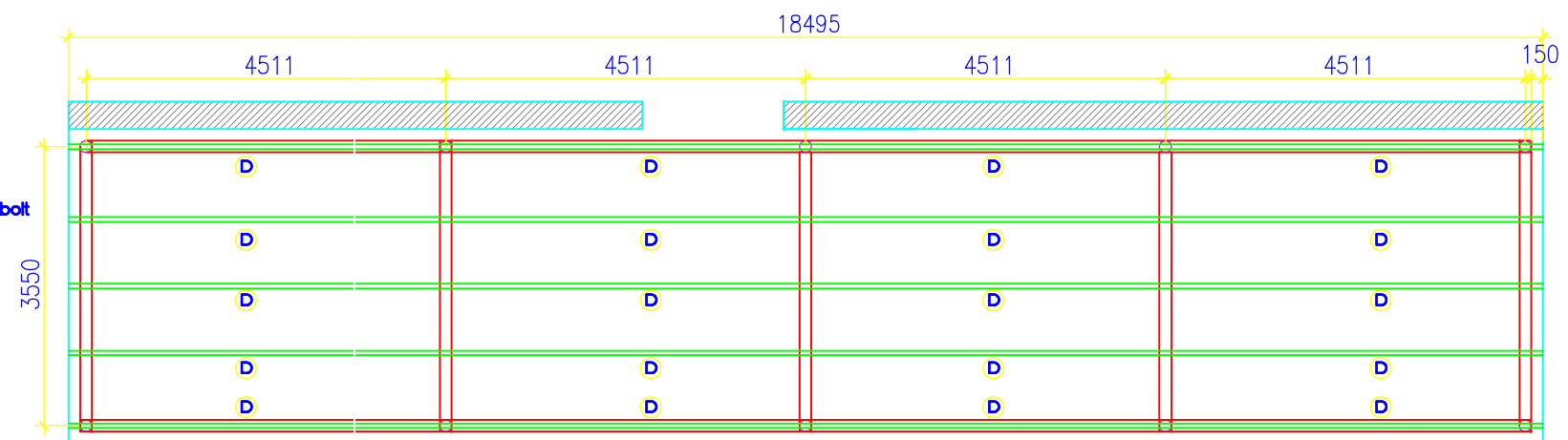

PLAN OF PURLINS AT ROOF

GMSD - KARNAL

DRAWING

KEY PLAN

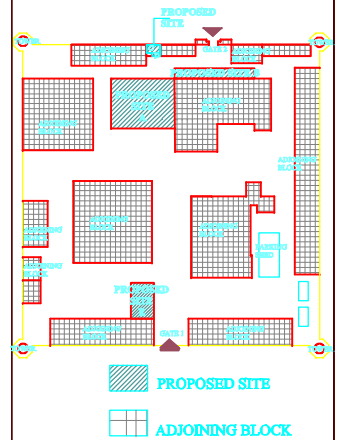

Note:-
(1) 2 Nos. 5 Amp. Plug Point to be Provided where Computer Outlet is Proposed at Ht. of 1.06M from Ground Level.

NOTES:

1. This drawing is copyright.
2. This drawing should not be reproduced or handed over to third party without consent of competent authority.
3. Do not scale from this drawing.
4. All dimensions are in millimetres unless noted otherwise.
5. These drawings are only indicative and not to be used for construction on site.
6. Do not make any structural changes on site. The same are not recommended.

S.NO.	REVISION (READ DOWNWARD)	DATE
1.		
2.		
1.	FOR TENDER	18-01-10
S.NO.	ISSUED TO (READ UPWARD)	DATE
1.	PROJECT	
UPGRADATION OF COLD CHAIN FACILITIES IN THE GOVERNMENT MEDICAL STORE DEPOTS AT DELHI KARNAL, HYDERABAD, MUMBAI, CHENNAI KOLKATA & GUWAHATI.		

CANOPY STRUCTURAL DETAILS	SCALE
(KARNAL)	JAN'2010
TITLE	DATE

OWNER:-

ARCHITECT:-

EL	DWG.NO.: GMSD/KAR/EL/01
	DEALT BY:

ARCHITECT :
SURINDER SAWHNEY ASSOCIATES
ARCHITECTS & DESIGN CONSULTANTS
571, SECTOR-18-B, CHANDIGARH
E-MAIL: surindersawhney@sify.com
PH:0172-2780535, FAX : 0172-2726627.